



*Welcome to Early Years  
Foundation Stage at Ad  
Astra Infant School*



# Our Vision



## 'Children First'

Our vision is to promote a love of learning in order to maximise the life chances of every child in our Trust. Through nurturing, high expectations and skilled teaching, we will have a lasting and positive impact on our local and wider community.

# Our Values



Our Trust will promote the following two sets of values.

## British Values

- Democracy
- Rule of Law
- Individual Liberty
- Mutual Respect
- Tolerance

## TEACH Values

- Trust
- Excellence
- Aspiration
- Collaboration
- Honesty

# Meet the Teachers



*Mrs Haddrell*



*Miss Bridgman*



*Mrs Ford*



# Meet the Teaching Assistants



Mrs Purbrick



Mrs Lewis



Mrs Leslie



Mrs Steinwartz



Mrs Watt

# Special Educational Needs



- ✓ If your child needs additional support in school, then the class teacher will contact you to discuss this.
- ✓ Your child may receive 'school support' and be put on the Special Educational Needs register.
- ✓ Additional targets can then be set which will be shared with you during a separate meeting. These targets will be reviewed once a term.
- ✓ Your child may then use an IEP card in their lessons, with their targets on, collecting stickers when they are successful in making progress towards their target.



Mrs Chandler  
(Inclusion Leader)



# Pastoral Care



✓ Our TEACH Trust schools are not just about academic achievements, but the safety and development of the whole child too.

✓ We recognise that, for *all our children* to achieve their full potential, we also need to take care of their emotional well-being.

✓ All staff in all the TEACH Trust schools work together to support the children to achieve their very best educationally, socially, physically and emotionally.



Mrs Penfold  
(Pastoral Care Worker)

# Next few weeks



- ✓ Getting to know their class
- ✓ Making friends
- ✓ Learning routines
- ✓ Reception Baseline Assessment
- ✓ Discover and Explore
- ✓ 'Oh no! It's a Gruffalo' topic



# General class routines



- ✓ Colour groups
- ✓ Bookbags and PE bags
- ✓ Water bottles
- ✓ Fruit
- ✓ Toilets
- ✓ Playtimes

# Uniform

	✓	✗
Trousers	Grey, black or charcoal tailored trousers. School conventional material. Full length	Jeans, corduroy, leggings, Lycra, skinny trousers
Jumper/ cardigan	Green with school logo	Other jumpers, hoodies, sweatshirts etc.
Skirts/ pinafore	Grey, black or charcoal knee length skirt/ dress	Fashion skirts or dresses, shorter than the knee
Socks and tights	Plain grey, black or white	Fashion tights, coloured or patterned socks/ tights, bare feet
Polo shirt	Plain white or with school logo	Coloured polo shirts, shirts with motifs
Shoes	Traditional flat black shoes. Velcro, laces, buckles or slip-ons.	Trainers, boots, high heels, wedges, open toed sandals, sling backs.

# Uniform



# Uniform



# Attendance



Being in school is vital for so many reasons:

- Achievement
- Wellbeing
- Wider development

Primary school children in KS2 who did not achieve EXS for reading, writing and maths missed on average 4 more days per school year than those whose performance exceeded the expected standard (2019).



✓ 7 areas of learning - 17 Early Learning Goals

## Prime areas

- ✓ Communication & Language
- ✓ Physical Development
- ✓ Personal, Social & Emotional Development

## Specific areas

- ✓ Mathematics
- ✓ Literacy
- ✓ Understanding the World
- ✓ Expressive Arts and Design





# Forest Schools



- ✓ Using tools
- ✓ Making fires
- ✓ Exploring
- ✓ Appreciating nature

The Teach Trust Forest School aims to promote the holistic development of all those involved, fostering resilient, confident, independent and creative learners. Through encouraging children to make a deep connection with nature and appropriately assess risk, we will inspire children to respect nature and foster an ethos of environmental stewardship.

# Growth Mindset

## What Kind of Mindset Do You Have?



I can learn anything I want to.  
When I'm frustrated, I persevere.  
I want to challenge myself.  
When I fail, I learn.  
Tell me I try hard.  
If you succeed, I'm inspired.  
My effort and attitude determine everything.



I'm either good at it, or I'm not.  
When I'm frustrated, I give up.  
I don't like to be challenged.  
When I fail, I'm no good.  
Tell me I'm smart.  
If you succeed, I feel threatened.  
My abilities determine everything.

# We are Growth Minded!

"I'll keep trying."

"I'm not going to give up."

"Mistakes help me learn."

"This may take a little more time."

"I've got this. Now what can I challenge myself with?"





# Achievosaurus



• In EYFS, we are keen to develop 'lifelong learners,' so developing the children's characteristics of learning are central to everything that we do. The children learn about the 'Achievosaurus' and they aspire to have similar learning attributes. The 'Achievosaurus' includes the following:



- 'Explorosaur' – who loves to explore everything around them

- 'Askaraptor' – who asks questions to find things out



- 'Tryatops' – who always tries new things, always tries their best and never gives up



# Achievosaurus

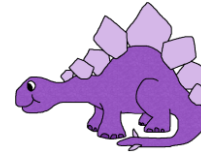

- 'Stickosaurus' – who sticks at tasks and perseveres
- 'Solveosaurus Rex' – who works hard to solve problems and improve things
- 'Thinkodocus' – who thinks carefully about what they learn
- 'Shareosaurus' – who works well with others and shares ideas

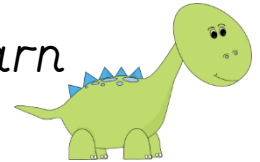

The children love to tell us which Achievosaurus they are being!

# Classroom Charter

- Rights' Respecting school – Gold Award (July, 2022)
- Rewards and consequences
  - \* Shooting star, rainbow, sun and cloud
  - \* Sparkle time
  - \* Certificates
- Gold 'Altogether Award'
- (Anti-bullying programme)







# A day in EYFS



8:35 – Fiddly fingers

8:45 – Register

8:50 – Phonics (Whizzy Word Workshop)

9:20 – Discover and Explore

10:00 – Storytime

10:15 – Playtime

10:30 – Maths

11:00 – Discover and Explore

11:35 – Topic Time

12:00 – Lunchtime (earlier during the first few weeks) **Reminder: We are a 'nut aware' school.**

12:55 – Register

1:00 – Topic

1:20 – Discover and Explore

2:20 – Review and story

2:25 – Handwriting

2:45 – STAR time

PE

Discovery Religion and Worldviews

Handwriting

PSHE

Assembly

Reading Workshop

Library

Music

ICT

# Dressing Up in Early Years



## Autumn term

- ✓ Sponsored Read – Julia Donaldson theme
- ✓ Christmas Jumper Day

## Spring term

- ✓ EYFS Grand Ball- prince and princess clothing/smart clothes
- ✓ Walt Disney Wonders performance- *this years theme TBC*
- ✓ World Book Day- favourite book character
- ✓ Pirate drama day - a pirate costume or accessories
- ✓ When I grow up day (Aspirations Day)



# Extra-ordinary events



- ✓ Bikeability
- ✓ Farm visit (£TBC)
- ✓ Crazy Creatures (£1.50)
- ✓ Space dome (£2.80)
- ✓ Voluntary contributions



# PE



*Caterpillars – Monday*

*Froglets- Tuesday*

*Ducklings - Wednesday*

- *PE kit labelled*
- *No earrings please*



# Handwriting



The letters are taught in 4 letter families:

Long ladder letters - l i t u j y

One armed robot letters - r b n m h k p

Curly caterpillar letters - c a d o s g q e f

Zig-zag monster letters - z x w v

# The importance of Reading



- ✓ Reading is key to all learning
- ✓ 'The best writers are always readers' (Pie Corbett)
- ✓ School policy - minimum of 3 home reads a week

[CJ reading.MOV](#)

## Why Can't I Skip My 20 Minutes of Reading Tonight?

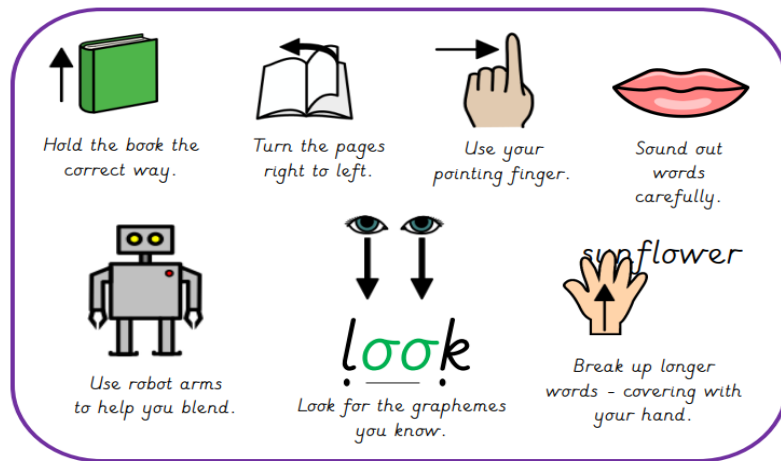

Student "A"  
reads **20 minutes**  
each day

3600 minutes in  
a school year

**1,800,000 words**

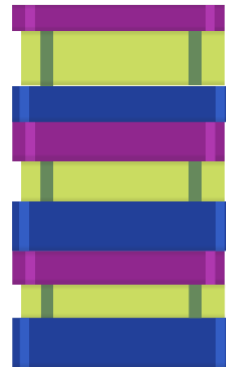

90th percentile

Student "B"  
reads **5 minutes**  
each day

900 minutes in  
a school year

**282,000 words**



50th percentile

Student "C"  
reads **1 minute**  
each day

180 minutes in  
a school year

**8,000 words**



10th percentile



# The importance of Reading



- ✓ Usually a more challenging text will be read in school than the one sent home
- ✓ Focus on phonics – sounding out and blending
- ✓ Comprehension focus during guided reading sessions
- ✓ Celebrate reading successes
- ✓ Changing reading books
- ✓ Library books
- ✓ Language development
- ✓ We encourage reading for enjoyment



## Show and tell books



Autumn Term	
Week beginning:	Colour group Show and Tell
Monday 31 <sup>st</sup> October	Orange
Monday 7 <sup>th</sup> November	Yellow
Monday 14 <sup>th</sup> November	Green
Monday 21 <sup>st</sup> November	Blue
Monday 28 <sup>th</sup> November	Red
Monday 5 <sup>th</sup> December	Orange
Monday 12 <sup>th</sup> December	Yellow

- ✓ Pictures and writing
- ✓ Objects



## Sound books

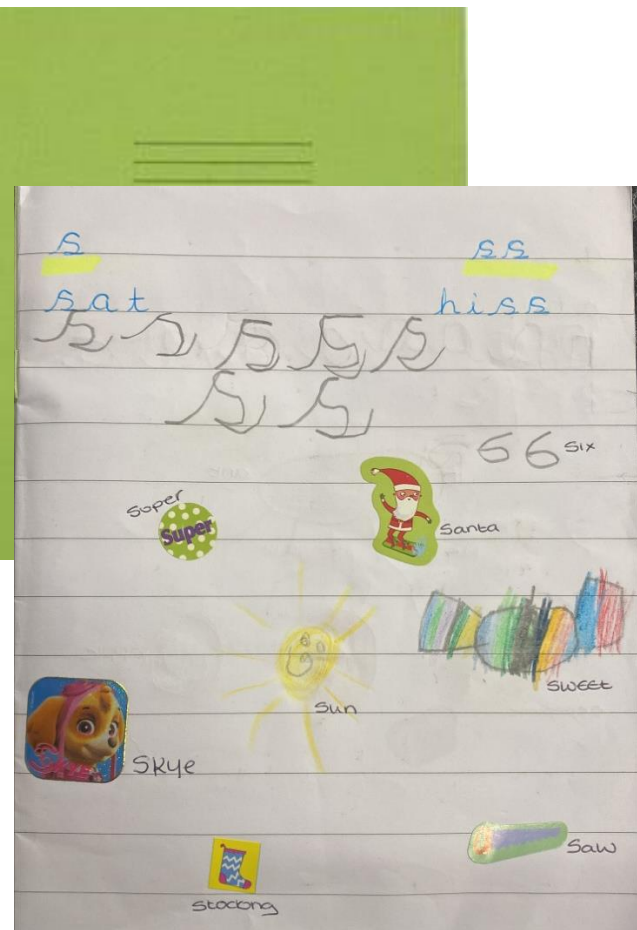

- ✓ Practise writing the individual letters
- ✓ Write words starting with that sound
- ✓ Draw pictures
- ✓ Stickers
- ✓ Find words on the way to school that start with the sound
- ✓ Key word cards



# Learning at Home



- ✓ *Topic home learning*
- ✓ *Weekly home challenges*
- ✓ *WOW moments – stars in coloured folder*

# Things to practise at home....



- ✓ Getting changed – putting jumper on the right way
- ✓ Doing coats up
- ✓ Putting on scarf, hat and gloves
- ✓ Using knife and fork
- ✓ Recognising and writing own name
- ✓ Counting on and back in 1s
- ✓ Counting sets of objects – moving them
- ✓ Naming shapes
- ✓ Listening to stories and talking about them

# Home and school links



## We really value your support

- United with a common purpose – Children First
- Become a parent helper/reading volunteer (please see letter and contact class teacher, school office or Mrs Doyle)
- Please volunteer to help on school trips if available
- Join and/or support our PTA

## We want to support you too

- School run training sessions e.g. phonics and maths workshops later in the year
- Parents consultation evenings (twice a year)
- School website





*Parent Teachers  
Association (PTA)*

*'Friends of Ad Astra'*

# PTA Events



*Thank you for  
listening*

